

SSI Model **M160** shredders process:

- High volume municipal waste
- Heavy industrial waste
- Passenger, truck and OTR tires
- Steel drums / ferrous
- Appliances
- Oversized bulky waste
- Wood / pallets
- Demolition waste
- Baled and bulky materials
- and more...

INDEPENDENT DUAL DRIVES

A unique feature of SSI's dual drive machines is that each shaft is directly splined to the drive. That means maximum power to each shaft. It also means fewer gears; therefore, fewer parts and less maintenance. Yet best of all, each drive can be set independently to give varying speeds in the cutting chamber a real advantage for optimum performance in many applications.

ELECTRIC OR HYDRAULIC

Model M160 shredders are available in both electric and hydraulic versions to meet your specific processing requirements. Factors to consider:

Electric drive when processing:

- Sorted, uniform materials
- Conveyor fed or metered materials
- Materials containing limited non-shreddables

Hydraulic drive when processing:

- Mixed or unsorted materials
- Batch fed materials
- Materials containing non-shreddables
- Materials requiring enhanced particle size or throughput control
- Installations requiring optional reduced voltage starting



SSI Advantages

High-torque, low-speed design

Delivers multipurpose shredding with greater on-line reliability and lower maintenance requirements than other technologies.

Dual direct drive motors

Provide improved efficiency and reliability. Alternate speed and torque combinations available.

Shock load protection feature

Protects shredder and drive components. Electric version offers patented SSP™ (Severe Shock Protection) controlled torque coupling. Hydraulic version utilizes multiple relief valves.

Auto reversal feature

Protects against overfeeding and damage by non-shreddables.

ACLS™ (Advanced Cutter Locking System)

Eliminates daily requirement to tighten cutter stack while improving shredder performance and cutter life.

Proprietary bearing protection

Isolates bearings from cutting chamber contamination and protects against bearing failure.

Convertible drive

Versatile design accommodates electric or hydraulic drive. Optional conversion package available.

SSI Shredding Systems, Inc.

9760 SW Freeman Drive
Wilsonville, Oregon 97070 USA
Phone: 503-682-3633 Fax: 503-682-1704
www.ssiworld.com

♻️ Printed on recycled paper PD-0M160

SSI MODEL M160

Standard cutting chamber (W x L) 64" x 101" (1625mm x 2555mm)
 Optional sizes available 75" (1905mm)

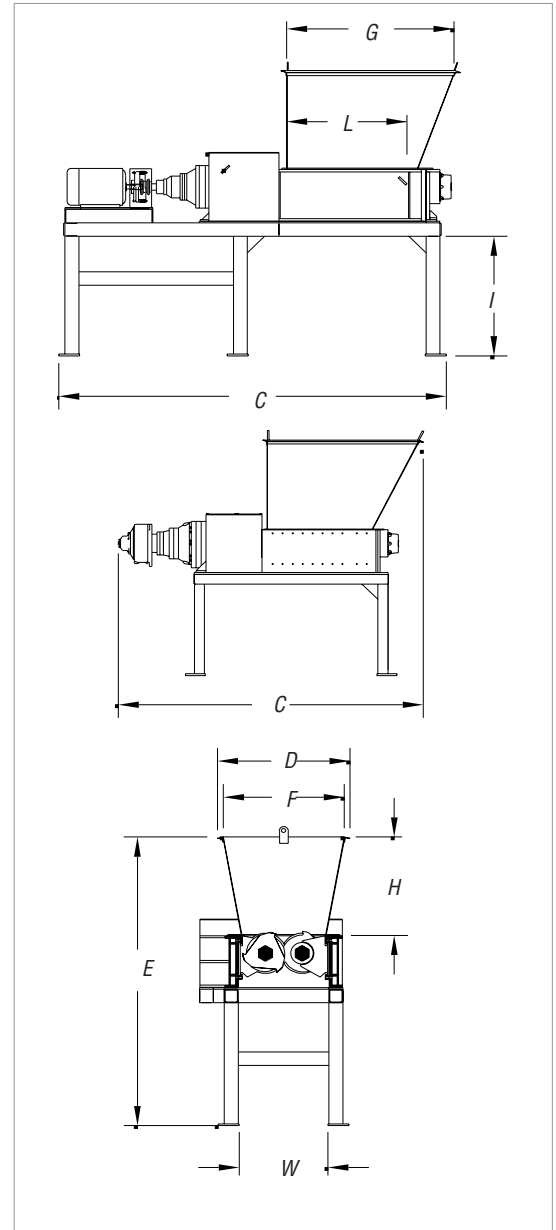

SHREDDER	MODEL M160ED	MODEL M160HD
Drive	Dual electric	Dual hydraulic
Number of electric motors	Two	Two (HPU)
Horsepower	400 HP (300kW)	400 HP (300kW)
HP Range	300-400 HP (225-300kW)	400-600 HP (300-450kW)
Voltage	460/3/60	460/3/60
Voltage options	Many - Consult factory	Many - Consult factory
Autochop feature	N/A	Included
Shock load protection	Yes (SSP™)	Yes (Multiple Relief)
Cutter thickness (nominal)	2" (50mm)	2" (50mm)
Cutter diameter	33.5" (850mm)	33.5" (850mm)
Cutter material	4140 HT	4140 HT
Shaft diameter	10" (254mm)	10" (254mm)
Cutting chamber (WxL)	64" x 101" (1625mm x 2555mm)	64" x 101" (1625mm x 2555mm)
Machine length (C)	245" (6223mm)	237" (6020mm)
Machine width (D)	80" (2032mm)	80" (2032mm)
Machine height (E)	169" (4293mm)	169" (4293mm)
Machine weight	73,000 lbs (33,113 kg)	70,000 lbs (31,752 kg)
Hopper opening (FxG)	96" x 144" (2440mm x 3660mm)	96" x 144" (2440mm x 3660mm)
Hopper height (H)	69" (1750mm)	69" (1750mm)
Stand height (I)	60" (1525mm)	60" (1525mm)
HPU configuration	N/A	Open loop
HPU dimensions	N/A	10' x 7.5' x 9' (3m x 2.3m x 2.7m)
HPU weight	N/A	11,000 lbs (5,000 kg)
Motor starting and protection devices are mounted in a single NEMA 4 enclosure. PLC and operator interface are mounted in a second NEMA 4 enclosure.		

SSI offers a full range of energy-efficient electric and hydraulic shredders as well as custom units to meet all processing requirements.

Standard Cutter Profiles



Note: Illustrations, specifications and descriptions presented reflect standard product at time of publication and are subject to change without notice. Dimensions are approximate. Photographs may include optional equipment and accessories. SSI offers compactors, balers, granulators, conveyors and classifiers as well as specialized motors, stands, hoppers, and mobile configurations. Consult factory to discuss your processing needs.

SSI Shredding Systems, Inc.

9760 SW Freeman Drive Wilsonville, Oregon 97070 USA
 Phone: 503-682-3633 Fax: 503-682-1704 www.ssiworld.com

